

BROADWAY BRIDGE GEOMETRIC APPROVAL DRAWING ALIGNMENT B

MARK THOMAS

701 UNIVERSITY AVENUE SUITE 200
SACRAMENTO, CALIFORNIA 95825

DRAWN BY: KD	APPROVED ON: _____	JOB NO. SA-17110	SHEET 1
CKD BY: ZS	BY: _____	FILE NO. XXX.dwg	OF 3
DATE: 9-2018	RCE NO.: _____		
SCALE: AS SHOWN			

LEGEND/ ABBREVIATIONS

- L1 LINE DATA (SEE TABLE)
- CURVE DATA (SEE TABLE)
- F FILL LIMITS
- C CUT LIMITS
- - - LEVEE SETBACK
- - - EXISTING ROW
- - - PROPOSED RETAINING WALL
- (A) INTERSECTION LOCATION
- (A-A) CROSS SECTION LOCATION

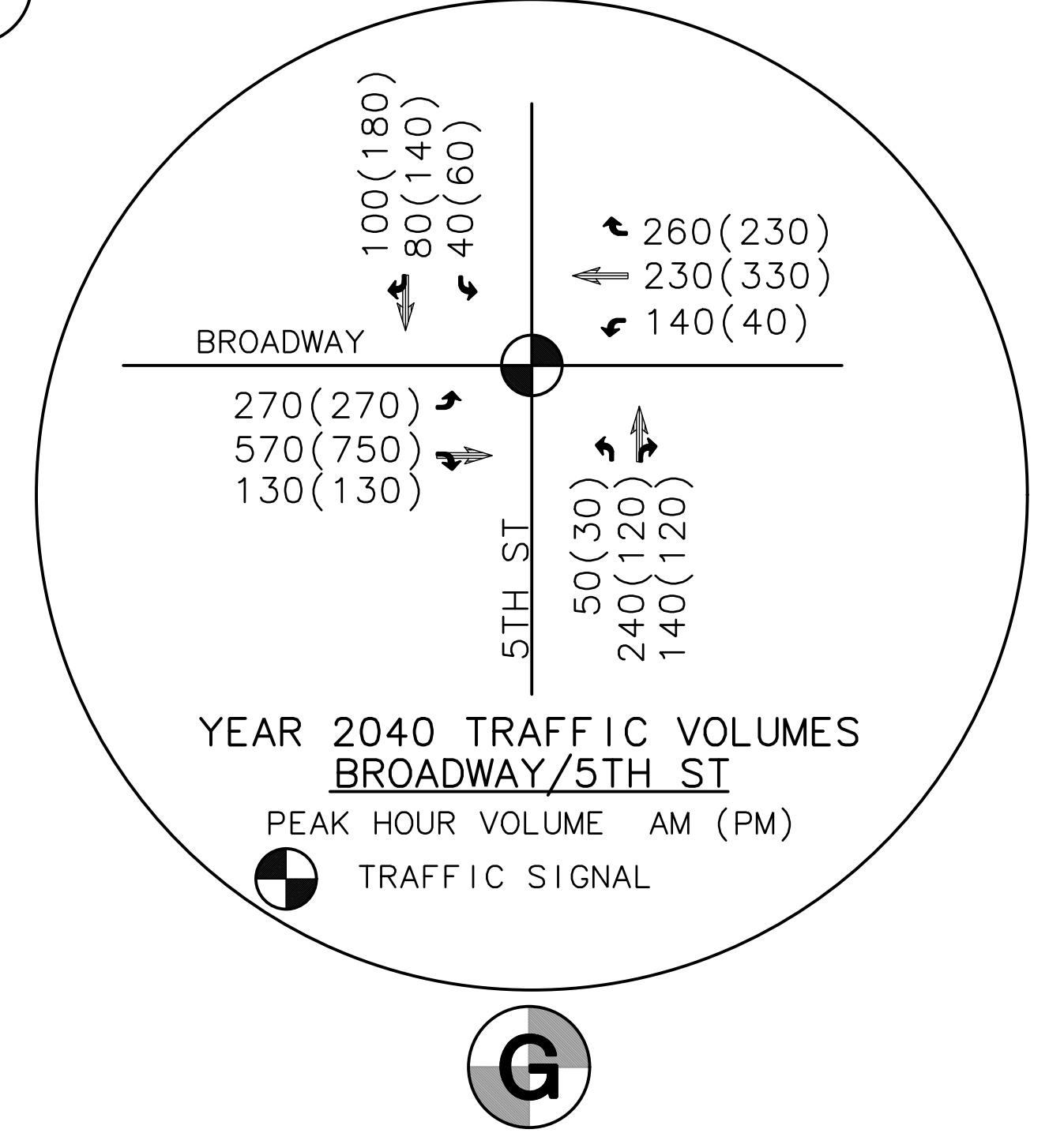
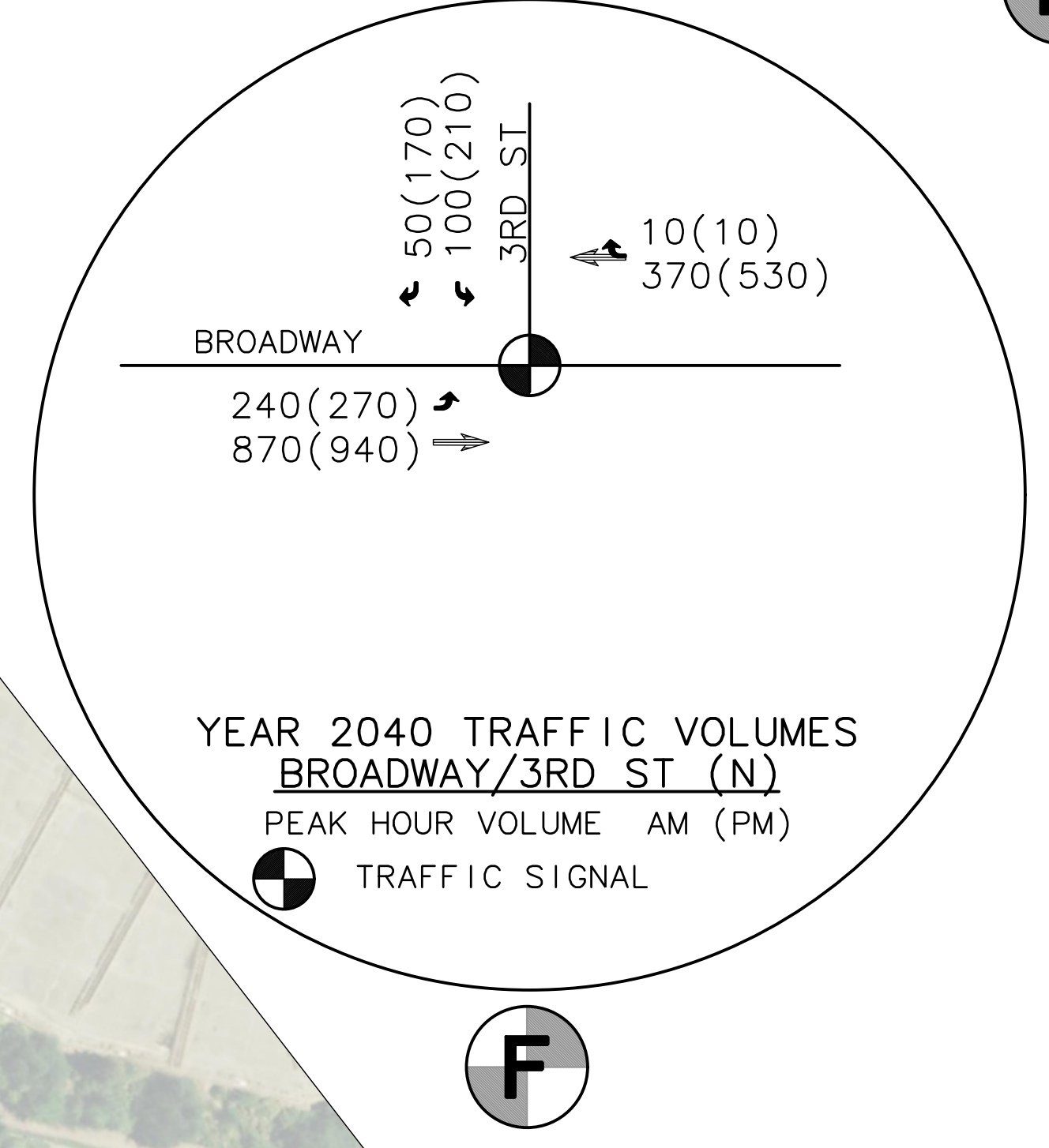
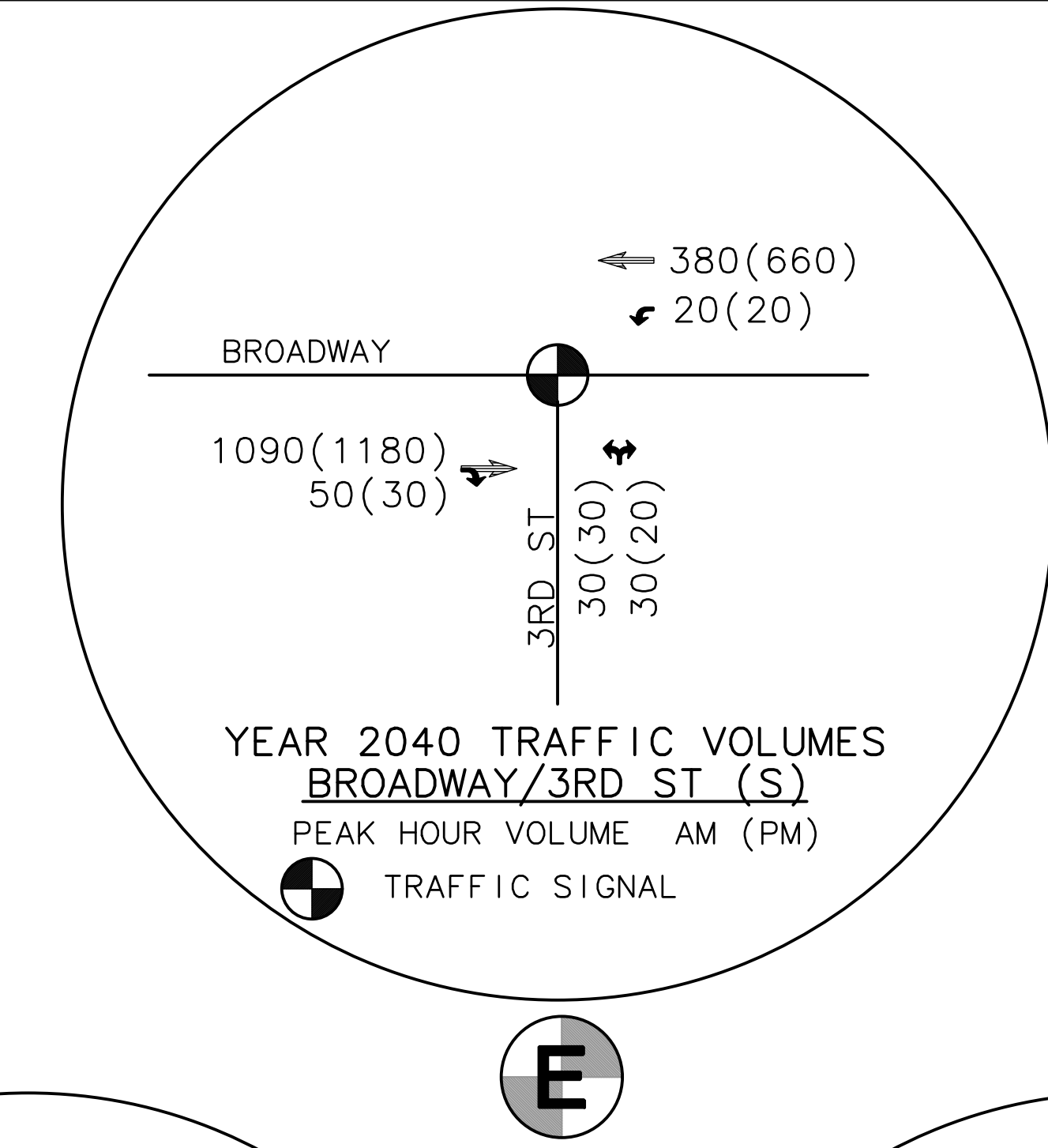
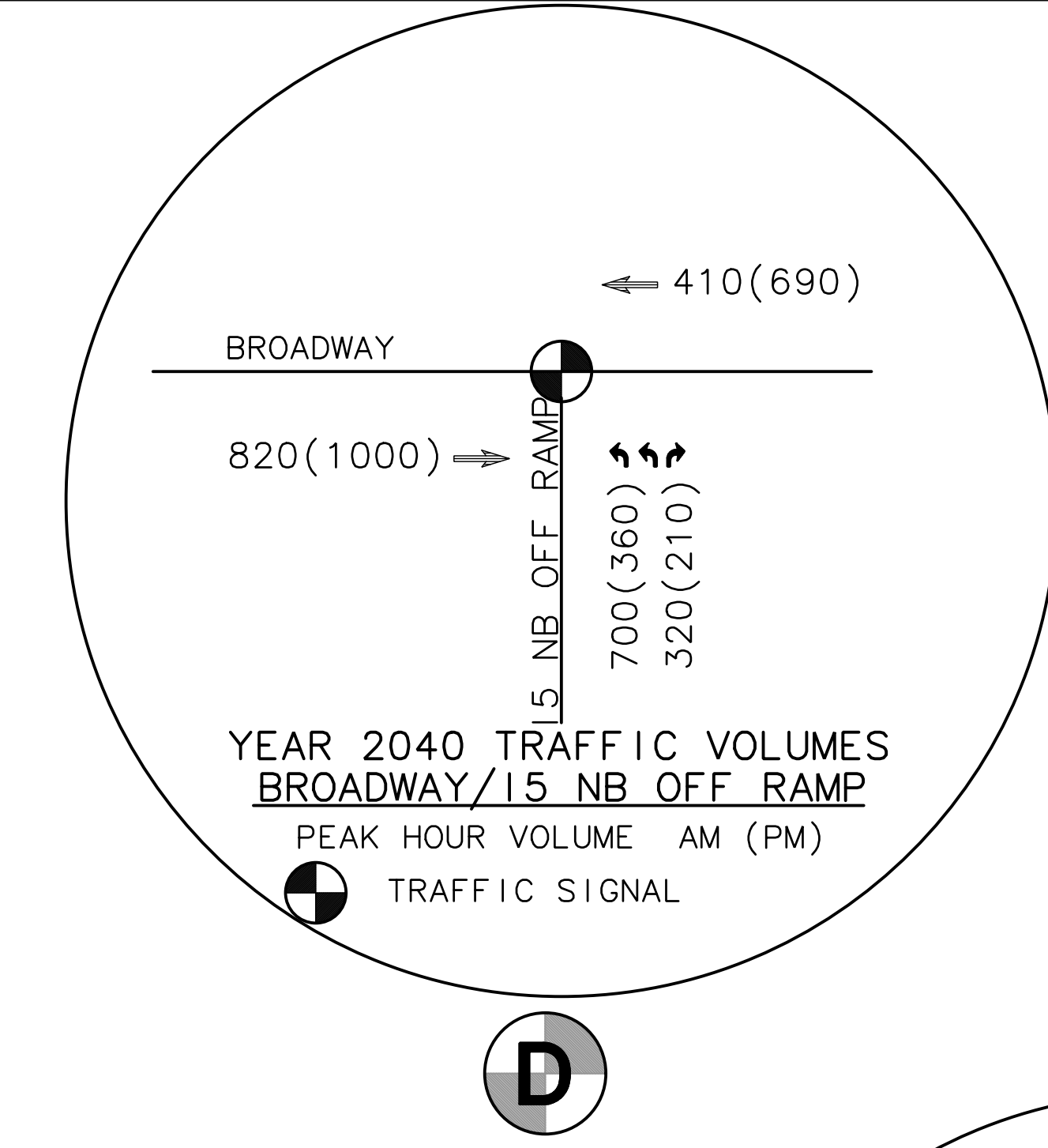
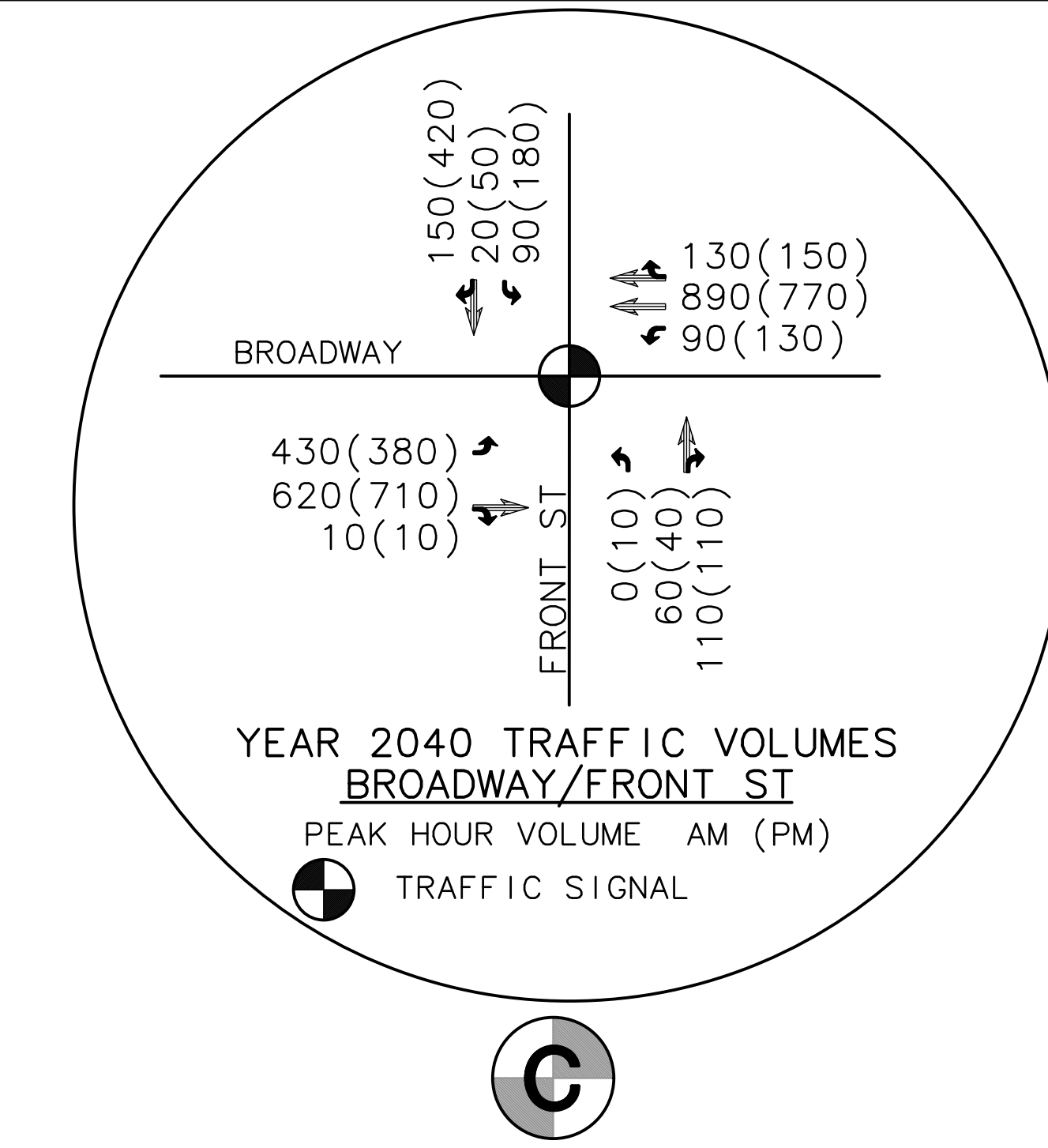
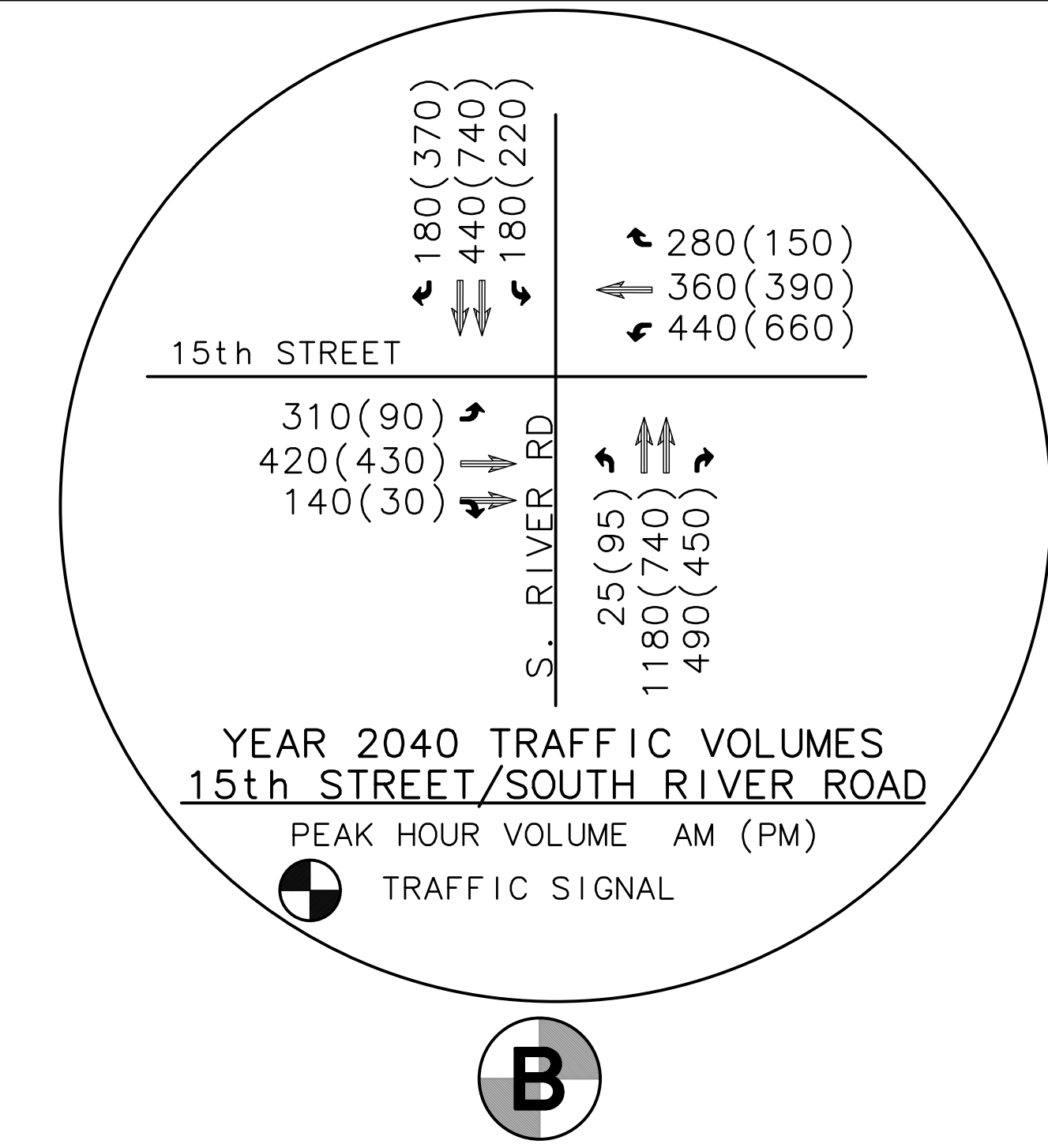
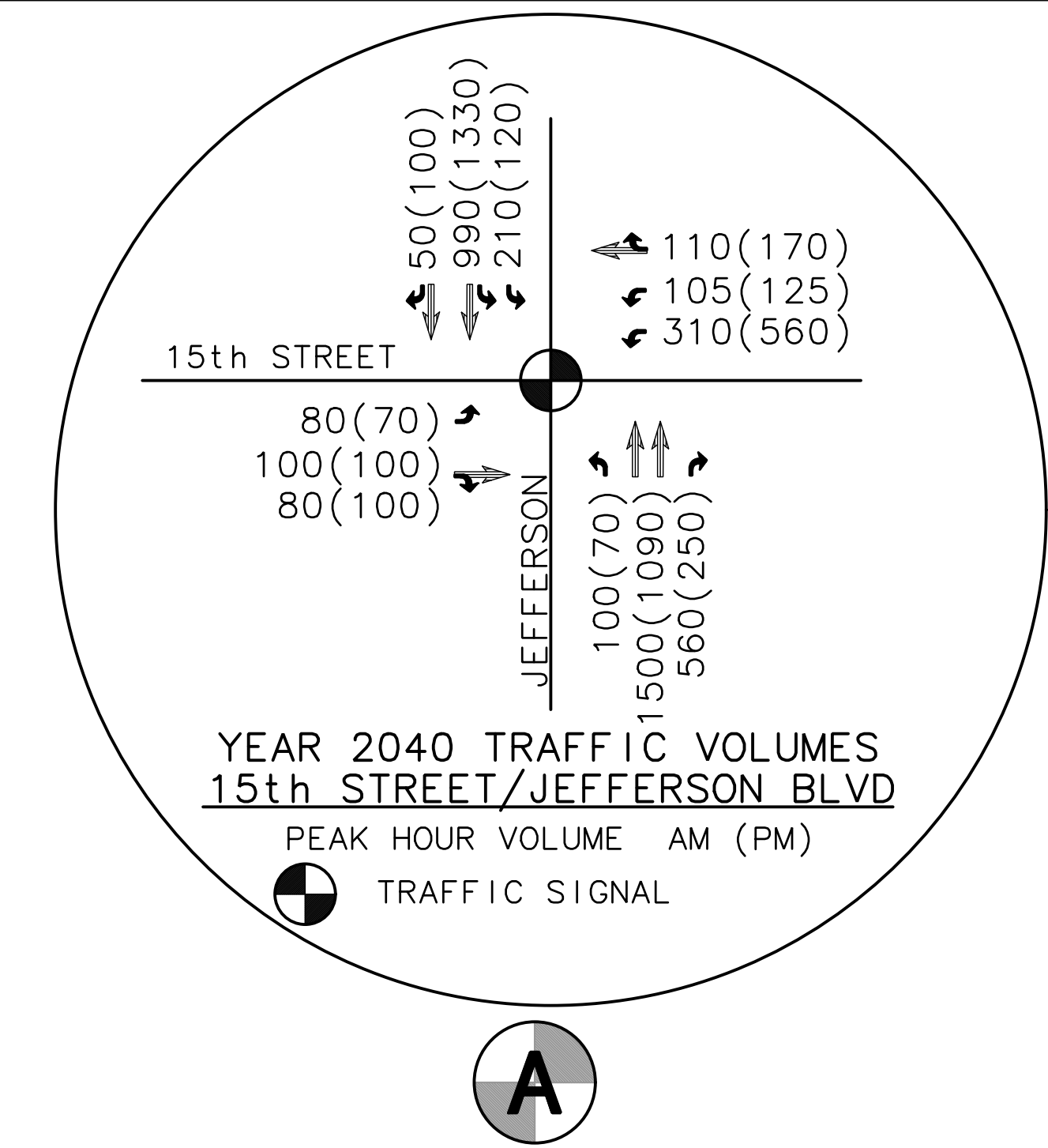

LINE DATA

LINE #	LENGTH	DIRECTION
L1	116.65'	N80°51'38"E
L2	1160.94'	S48°42'31"E
L3	2914.39'	S71°22'49"E

CURVE DATA

CURVE #	RADIUS	DELTA	TANGENT	LENGTH
C1	1200.00'	50°25'50"	565.07'	1056.22'
C2	601.99'	23°57'57"	127.77'	251.80'

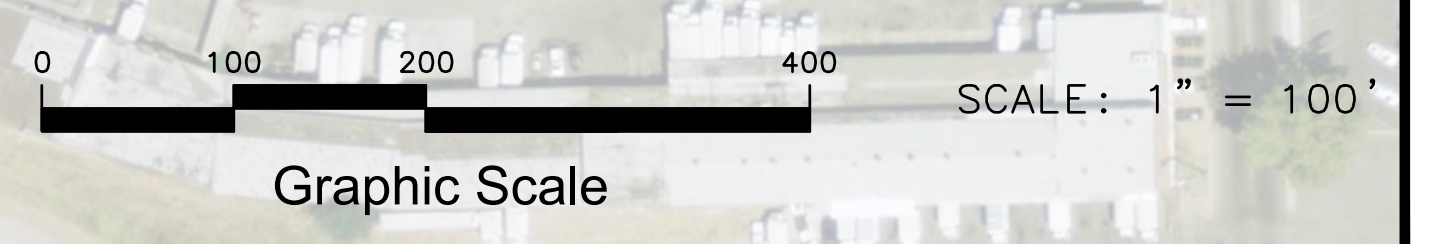


BROADWAY BRIDGE GEOMETRIC APPROVAL DRAWING ALIGNMENT B



701 UNIVERSITY AVENUE SUITE 200
SACRAMENTO, CALIFORNIA 95825

DRAWN BY: <u>KD</u>	APPROVED ON: _____	JOB NO. SA-17110
CKD BY: <u>ZS</u>	BY: _____	SHEET 2
DATE: <u>9-2018</u>	RCE NO.: _____	FILE NO. XXX.dwg
SCALE: AS SHOWN		SHEET 3



15TH STREET / BROADWAY

"B" LINE
SCALE: H = 1"=50'
V = 1"=5'



15TH STREET / BROADWAY

"B" LINE
SCALE: H = 1"=50'
V = 1"=5'

MATCHLINE - "B" 37+50 SEE ABOVE

MATCHLINE - "B" 37+50 SEE BELOW

**BROADWAY BRIDGE
GEOMETRIC APPROVAL DRAWING
ALIGNMENT B**

**MARK
THOMAS**

701 UNIVERSITY AVENUE SUITE 200
SACRAMENTO, CALIFORNIA 95825

DRAWN BY: <u>KD</u>	APPROVED ON: _____	JOB NO. SA-17110	SHEET 3
CKD BY: <u>ZS</u>	BY: _____	FILE NO. XXX.dwg	OF 3
DATE: <u>9-2018</u>	RCE NO.: _____		
SCALE: <u>AS SHOWN</u>			

